

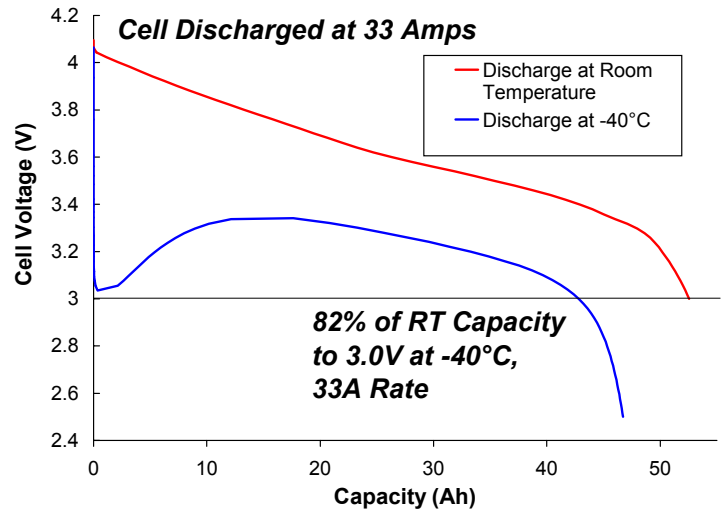

**Model NCP55-2**  
**3.6V, 55Ah Lithium Ion Cell**

*Typical Discharge Curves*



*Performance Data*

*Physical Dimensions*

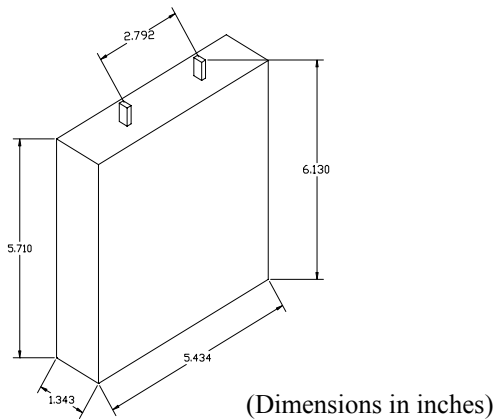

<b>Cathode:</b> Lithiated Nickel Cobalt Oxide	<b>Nominal Voltage:</b> 3.6 VDC
<b>Anode:</b> Graphite	<b>Nominal Weight:</b> 1.582 kg
<b>Electrolyte:</b> EC:DMC:DEC	<b>Cycle Life:</b> > 2000 Cycles
<b>Nominal Capacity:</b> 55 Ah @ C/5	<b>Energy Density:</b> 291 Wh/l
<b>Pulse Current:</b> 300 A (0.1 sec.)	<b>Specific Energy:</b> 125.2 Wh/kg
<b>Continuous Current:</b> 100 A (20 deg. C)	<b>Coulombic Efficiency:</b> 99%
<b>Dimensions: (mm)</b> 138W x 34T x 145H	<b>Fade Rate:</b> 0.02%/Cycle
<b>Operating Temperature Range:</b> -20C to +50C	

**Lithion, Inc.**  
**82 Mechanic St.**  
**Pawcatuck, CT 06379**  
**PH:(860) 599-1100 FAX:(860) 599-5122**  
**www.lithion.com**